

DRIVE PIN, UNIVERSAL HEAD

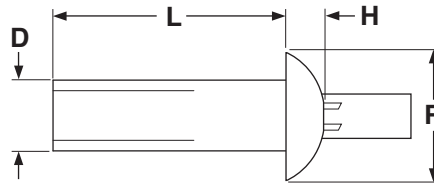

UNIVERSAL HEAD DRIVE PIN RIVETS — ALL ALUMINUM & ALUMINUM/STAINLESS																		
Part Number	D Shank Diameter (± .001)	L Length (+.010, -.005)	Grip Range		R Head Diameter (+.005, -.015)	H Head Height (± .005)	Part Number	D Shank Diameter (± .001)	L Length (+.010, -.005)	Grip Range		R Head Diameter (+.005, -.015)	H Head Height (± .005)					
			Min	Max						Min	Max							
05031AUSS	.125	.156	.015	.046	.250	.054	10813AUA	.187	.969	.766	.859	.375	.080					
05063AUSS		.156	.046	.078			10875AUA		1.031	.828	.922							
05094AUSS		.188	.078	.109			101000AUA		1.156	.953	1.047							
05125AUA		.219	.109	.141			101125AUA		1.281	1.078	1.172							
05156AUA		.250	.141	.172			14094AUA	.250	.250	.047	.141	.500	.107					
05188AUA		.281	.172	.203			14125AUA		.281	.078	.172							
05219AUA		.313	.203	.235			14188AUA		.344	.141	.234							
05250AUA		.344	.235	.266			14250AUA		.406	.203	.297							
05281AUA		.375	.266	.297			14313AUA		.469	.266	.359							
05313AUA		.406	.297	.328			14375AUA		.531	.328	.422							
05344AUA		.438	.328	.360			14438AUA		.594	.391	.484							
05375AUA		.469	.360	.391			14500AUA		.656	.453	.547							
05406AUA		.500	.391	.422			14563AUA		.719	.516	.609							
05438AUSS		.531	.422	.453			14625AUA		.781	.578	.672							
07031AUSS		.156	.188	.015			.046		14688AUA	.844	.641			.735	.625	.138		
07063AUSS	.188		.046	.078	14750AUA	.906	.703		.797									
07094AUSS	.219		.078	.109	14813AUA	.969	.766		.860									
07125AUA	.250		.109	.141	14875AUA	1.031	.828		.922									
07156AUA	.281		.141	.172	14938AUA	1.094	.891		.985									
07188AUA	.313		.172	.203	141000AUA	1.156	.953	1.047										
07219AUA	.344		.203	.234	141125AUA	1.281	1.078	1.172										
07250AUA	.375		.234	.266	141375AUA	1.531	1.328	1.422										
07281AUA	.406		.266	.297	31188AUA	.313	.438	.132	.242	.750	.166							
07313AUA	.438		.297	.328	31281AUA		.531	.226	.336									
07344AUA	.469		.328	.360	31375AUA		.625	.320	.430									
07406AUA	.531		.391	.422	31469AUA		.719	.414	.523									
07438AUSS	.563		.422	.453	31563AUA		.813	.508	.617									
07500AUSS	.625		.484	.515	31656AUA		.906	.602	.711									
07531AUSS	.656		.515	.546	31750AUA		1.000	.696	.805									
07563AUSS	.688	.546	.578	31844AUA	1.094		.790	.899										
07625AUSS	.750	.609	.640	31938AUA	1.188		.884	.993										
All sizes in gray-shaded area have stainless steel pins.								311031AUA	1.282			.978	1.087					
10094AUA	.187	.250	.047	.141	.375		.080	37188AUA	.375			.500	.125	.250	.750	.166		
10125AUA		.281	.078	.172				37281AUA				.594	.219	.344				
10188AUA		.344	.141	.234				37375AUA				.688	.313	.438				
10250AUA		.406	.203	.297				37469AUA				.781	.406	.531				
10313AUA		.469	.266	.359				37563AUA				.875	.500	.625				
10375AUA		.531	.328	.422		37656AUA		.969		.594	.719							
10438AUA		.594	.391	.484		37750AUA		1.063		.688	.813							
10500AUA		.656	.453	.547		37844AUA		1.157		.782	.907							
10563AUA		.719	.516	.609		37938AUA		1.250		.875	1.000							
10625AUA		.781	.578	.672		371031AUA		1.345		.970	1.094							
10688AUA		.844	.641	.734														

RIVETS

DRIVE PIN, UNIVERSAL HEAD

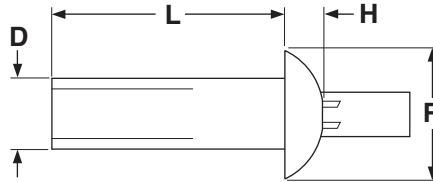

UNIVERSAL HEAD DRIVE PIN RIVETS—STEEL													
Part Number	D	L	Grip Range		R	H	Part Number	D	L	Grip Range		R	H
	Shank Diameter (± .001)	Length (+.010, -.005)	Min	Max	Head Diameter (+.005, -.015)	Head Height (± .005)		Shank Diameter (± .001)	Length (+.010, -.005)	Min	Max	Head Diameter (+.005, -.015)	Head Height (± .005)
37188SUS	.375	.500	.125	.250	.750	.166	37375SUS	.375	.688	.313	.438	.750	.166
37281SUS		.594	.219	.344									

Description	A two-piece fastening system consisting of (1) a self-contained pin within (2) the body of a tubular-shaped rivet with a dome-shaped head. The head is approximately twice as wide as the shank diameter. The top of the rivet has an opening through which the pin protrudes. The opposite end of the rivet is enclosed but with two cross-wise slits cut into the body extending from the tip, up the shank a limited distance.	
Applications/ Advantages	Drive pin rivets can join two or more pieces of low-density metal without the use of special installation tools. The rivet is inserted into pre-drilled, aligned holes and is set in place by striking the top of the pin with a hammer so that the pin is flush with the top of the head. This action causes the pin to drive through the opposite end and flare out in four directions creating a head on the blind side of the fastening. Drive pins have superior shear strength to standard break stem rivets because the pin remains inside of the installed rivet for its entire length. The universal head is the most versatile variety of drive pin, giving the neat, finished look of the brazier but with a lower head profile.	
Material	Aluminum Body <i>Body:</i> Aluminum alloy 2117 H15 or equivalent alloy <i>Pin (1/8 & 5/32 diam):</i> 302 series Stainless Steel <i>Pin (3/16 thru 3/8 diam):</i> Aluminum alloy 2024 T4 or equivalent alloy	Steel Body <i>Body:</i> AISI 1006 - 1008 or equivalent steel, zinc-plated <i>Pin:</i> AISI 1008 or equivalent steel, zinc-plated
Shear Strength (approximate)	<i>1/8" diameter:</i> 480 lbs. (w/Stainless pin) <i>5/32" diameter:</i> 715 lbs. (w/Stainless pin) <i>3/16" diameter:</i> 700 lbs. (w/Aluminum pin) <i>1/4" diameter:</i> 1030 lbs. (w/Aluminum pin) <i>5/16" diameter:</i> 1490 lbs. (w/Aluminum pin) <i>3/8" diameter:</i> 2300 lbs. (w/Aluminum pin)	<i>3/8" diameter:</i> 3000 lbs. (w/Steel pin)
Tensile Strength (approximate)	<i>1/8" diameter:</i> 175 lbs. (w/Stainless pin) <i>5/32" diameter:</i> 310 lbs. (w/Stainless pin) <i>3/16" diameter:</i> 360 lbs. (w/Aluminum pin) <i>1/4" diameter:</i> 815 lbs. (w/Aluminum pin) <i>5/16" diameter:</i> 1480 lbs. (w/Aluminum pin) <i>3/8" diameter:</i> 1795 lbs. (w/Aluminum pin)	<i>3/8" diameter:</i> 2500 lbs. (w/Steel pin)

PART NUMBER COMPARISON-UNIVERSAL HEAD DRIVE PINS, STEEL BODY/STEEL PIN					
Catalog	Indux	Southco®	Catalog	Indux	Southco®
37188SUS	31-12-06S	38-112-06-91	37375SUS	31-12-12S	38-112-12-91
37281SUS	31-12-09S	38-112-09-91			

Southco® is a registered trademark of Southco Inc. Kanebridge does not sell Southco® products.

DRIVE PIN, UNIVERSAL HEAD

PART NUMBER COMPARISON-UNIVERSAL HEAD DRIVE PINS, ALUMINUM BODY/STAINLESS PIN					
Catalog	Indux	Southco®	Catalog	Indux	Southco®
05031AUSS	31-04-01	38-104-01-13	07094AUSS	31-05-03	38-105-03-13
05063AUSS	31-04-02	38-104-02-13	07125AUA	31-05-04	38-105-04-13
05094AUSS	31-04-03	38-104-03-13	07156AUA	31-05-05	38-105-05-13
05125AUA	31-04-04	38-104-04-13	07188AUA	31-05-06	38-105-06-13
05156AUA	31-04-05	38-104-05-13	07219AUA	31-05-07	38-105-07-13
05188AUA	31-04-06	38-104-06-13	07250AUA	31-05-08	38-105-08-13
05219AUA	31-04-07	38-104-07-13	07281AUA	31-05-09	38-105-09-13
05250AUA	31-04-08	38-104-08-13	07313AUA	31-05-10	38-105-10-13
05281AUA	31-04-09	38-104-09-13	07344AUA	31-05-11	38-105-11-13
05313AUA	31-04-10	38-104-10-13	07406AUA	31-05-13	38-105-13-13
05344AUA	31-04-11	38-104-11-13	07438AUSS	31-05-14	38-105-13-13
05375AUA	31-04-12	38-104-12-13	07500AUSS	31-05-16	38-105-16-13
05406AUA	31-04-13	38-104-13-13	07532AUSS	31-05-17	38-105-17-13
05438AUSS	31-04-14	38-104-14-13	07563AUSS	31-05-18	38-105-18-13
07031AUSS	31-05-01	38-105-01-03	07625AUSS	31-05-20	38-105-20-13
07063AUSS	31-05-02	38-105-02-13			

UNIVERSAL HEAD Drive Pin Rivets, Aluminum					
Kanebridge	Indux	Southco®	Kanebridge	Indux	Southco®
10094AUA	31-06-03	38-106-02-16	14750AUA	31-08-24	38-108-24-16
10125AUA	31-06-04	38-106-04-16	14813AUA	31-08-26	38-108-26-16
10188AUA	31-06-06	38-106-06-16	14875AUA	31-08-28	38-108-28-16
10250AUA	31-06-08	38-106-08-16	14938AUA	31-08-30	38-108-30-16
10313AUA	31-06-10	38-106-10-16	141000AUA	31-08-32	38-108-32-16
10375AUA	31-06-12	38-106-12-16	141125AUA	31-08-36	38-108-36-16
10438AUA	31-06-14	38-106-14-16	141375AUA	31-08-44	38-108-44-16
10500AUA	31-06-16	38-106-16-16	31188AUA	31-10-06	38-110-06-16
10563AUA	31-06-18	38-106-18-16	31281AUA	31-10-09	38-110-09-16
10625AUA	31-06-20	38-106-20-16	31375AUA	31-10-12	38-110-12-16
10688AUA	31-06-22	38-106-22-16	31469AUA	31-10-15	38-110-15-16
10750AUA	31-06-24	38-106-24-16	31563AUA	31-10-18	38-110-18-16
10813AUA	31-06-26	38-106-26-16	31656AUA	31-10-21	38-110-21-16
10875AUA	31-06-28	38-106-28-16	31750AUA	31-10-24	38-110-24-16
101000AUA	31-06-32	38-106-32-16	31844AUA	31-10-27	38-110-27-16
101125AUA	31-06-36	38-106-36-16	31938AUA	31-10-30	38-110-30-16
14094AUA	31-08-03	38-108-02-16	311031AUA	31-10-33	-
14125AUA	31-08-04	38-108-04-16	37188AUA	31-12-06	38-112-06-16
14188AUA	31-08-06	38-108-06-16	37281AUA	31-12-09	38-112-09-16
14250AUA	31-08-08	38-108-08-16	37375AUA	31-12-12	38-112-12-16
14313AUA	31-08-10	38-108-10-16	37469AUA	31-12-06	38-112-15-16
14375AUA	31-08-12	38-108-12-16	37563AUA	31-12-18	38-112-18-16
14438AUA	31-08-14	38-108-14-16	37656AUA	31-12-21	38-112-21-16
14500AUA	31-08-16	38-108-16-16	37750AUA	31-12-24	-
14563AUA	31-08-18	38-108-18-16	37844AUA	31-12-27	-
14625AUA	31-08-20	38-108-20-16	37938AUA	31-12-30	-
14688AUA	31-08-22	38-108-22-16	371031AUA	31-12-33	-